

CH horizontal plate lifting clamps



Lifting clamps for safe transportation of steel plates in horizontal position. For hoisting steel plates up to hardness 37 RC (345 HB).

Properties

- WLL and size of the jaw opening are clearly indicated on the clamp.
- Suitable for hoisting and horizontal transport of steel plates that do not bend.
- These clamps can also be applied under a lifting frame or chain sling.
- Always use in pair.
- Low weight and compact design.
- Safety factor of at least 5 x WLL.
- Each clamp is 2 x WLL testloaded.

Application

- For lifting steel plates up to hardness 37 RC (345 HB).
- For the safe transport of steel plates in horizontal position.

Norm:

- EN12100-1/2, EN13155, AS4991, ASME-B30,20

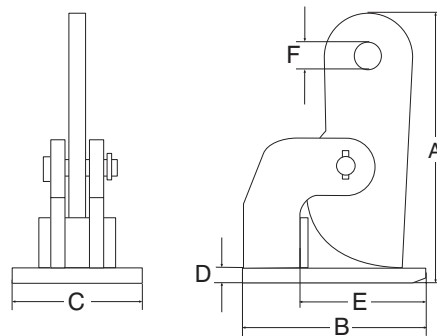

Safe workload when used under different angles

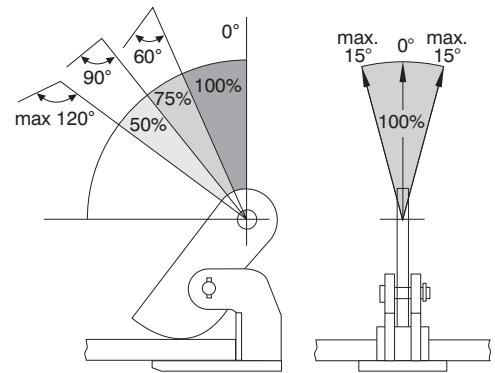

Type	WLL /pair (kg)	Jaw opening (mm)	A (mm)	B (mm)	C (mm)	D (mm)	E (mm)	F (mm)	Weight /pair (kg)	ProductId
CH-1.0	1000/2	0- 35	188	140	65	10	100	25	5.2/2	3365001
CH-2.0	2000/2	0- 60	290	180	90	15	115	31	15/2	3365002
CH-4.0	4000/2	0- 60	306	220	105	25	145	31	26/2	3365004
CH-6.0	6000/2	0- 60	306	220	110	25	145	31	26/2	3365006
CH-8.0	8000/2	0- 60	335	225	120	35	135	31	36/2	3365008
CH-10.0	10000/2	0- 60	335	225	120	35	135	31	40/2	3365010
CH-2.0/L	2000/2	0-100	380	180	90	15	120	31	18/2	3365102
CH-4.0/L	4000/2	0-100	415	220	105	25	145	31	30/2	3365104
CH-6.0/L	6000/2	0-100	415	220	120	25	145	31	32/2	3365106
CH-8.0/L	8000/2	0-100	430	225	120	35	135	31	44/2	3365108
CH-10.0/L	10000/2	0-100	430	225	120	35	135	31	46/2	3365110